

Control box **RPP10**



REAC Power Pack – RPP10 is a 2.9 Ah lead battery, intended to be used as a power source for REAC Control Boxes RCB11 and RCB12.

Standard features

Output power	24 VDC
Batteries	2.9 Ah
	Ventilated housing
Charger	24 VDC charger ¹
IP- class	IPX6
Weight	2.4 kg
Operating temperature	-15 °C to +50 °C
Storage temperature	-20 °C to +50 °C
Color	Black (RAL 9005) or White (RAL 9016)
EMC conformity	IEC/EN 61000-6-2: 2005 (C1:2005) IEC/EN 61000-6-3: 2007 IEC/EN 60601-1-2: 2015 ISO 7176-21: 2009
Flammability rating	UL94V-0

Options

Charger	Adaption for different countries
---------	----------------------------------

Dimensions

¹ Only charger supplied by REAC is allowed to be used

Power Pack **RPP10**

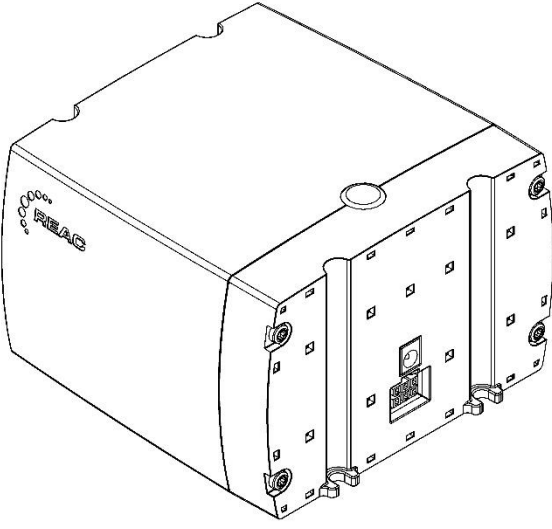
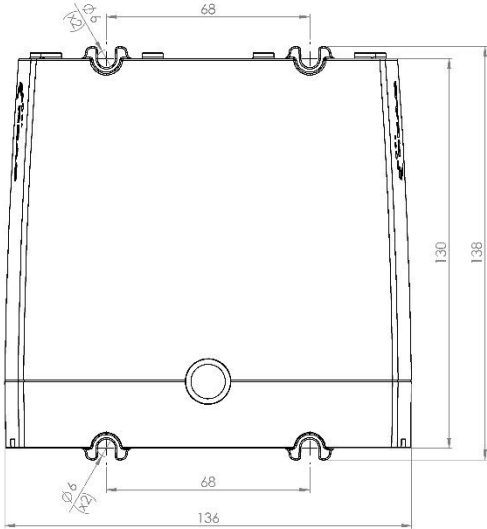
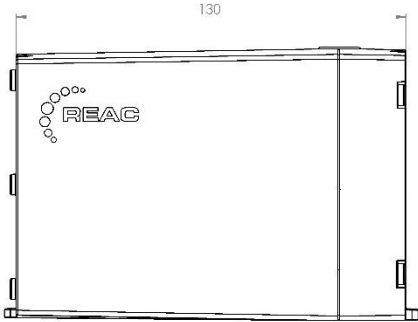
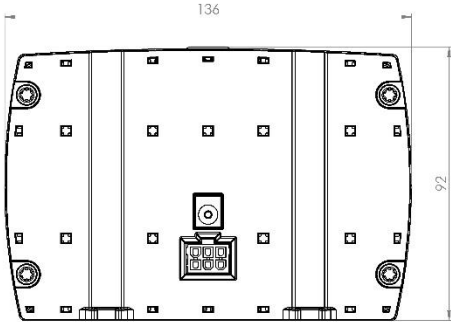

© REAC, April 2018, Issue 1.0

REAC is continuously developing our products and can make changes without prior notice. Therefore we can't guarantee that the information stated on our webpage or in our written material always is up to date, nor can we take responsibility for any misinterpretation of our written context. Technical specification might change due to load and external circumstances. REAC products shall be tested in its intended application before use.

REAC AB
Forsbrogatan 4
662 34 Åmål, Sweden

REAC Poland Sp. z o.o
Ul. Sulejowska 45
97-300 Piotrków Trybunalski, Poland

www.reac.se
E-mail: info@reac.se
Phone: +46 532 78 50 00